

ECM Machine – CI



EMAG ECM – CI

The Comfort Integrated (CI) model is the perfect entry level system into the ECM process.

- » Manual or semi-automatic version as starter system
- » Fast upgrade to full automation
- » Smart software and hardware interfaces

The ECM machining area, control cabinet with control system and electrolyte management system are all mounted on one machine frame (single frame). This means that the CI has a small footprint, is compact and can be transported with a forklift.

The CI is ideal for the following:

- » ECM machining
 - » ECM drilling
 - » ECM “broaching”
 - » ECM deburring
- on a wide range of components.

EMAG ECM GmbH

August-Robert-Wieland-Str. 2 | 74405 Gaildorf | Germany
Phone: +49 (0) 7971 / 9620-0 | Fax: +49 (0) 7971 / 9620-15
Email: ecm@emag.com | Website: www.emag.com



CI – Comfort Integrated

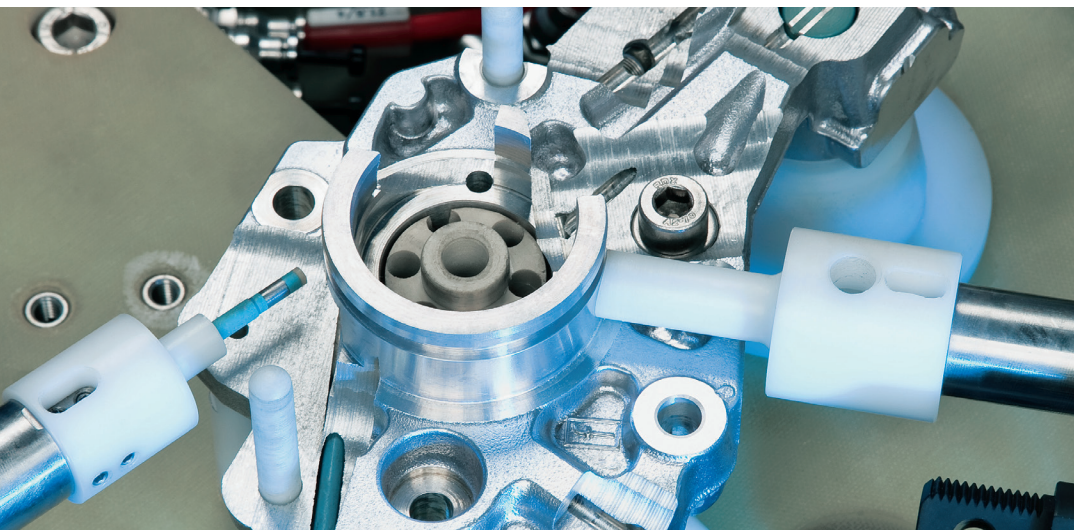

EMAG ECM – CI:

- + Compact design with integrated electrolyte filtration system
- + Scalable generator technology / pulse technology
- + SIEMENS S7-300 machine control unit
- + All parameters are monitored by a control unit
- + Quill stroke with safety interlock
- + Pulse duration from 50 μ s to DC (direct current)
- + Manual or semi-automatic version as starter system
- + Fast upgrade to full automation
- + Options available for improving processes and productivity
- + Also optionally available with two machining areas in the form of the CI-DUO

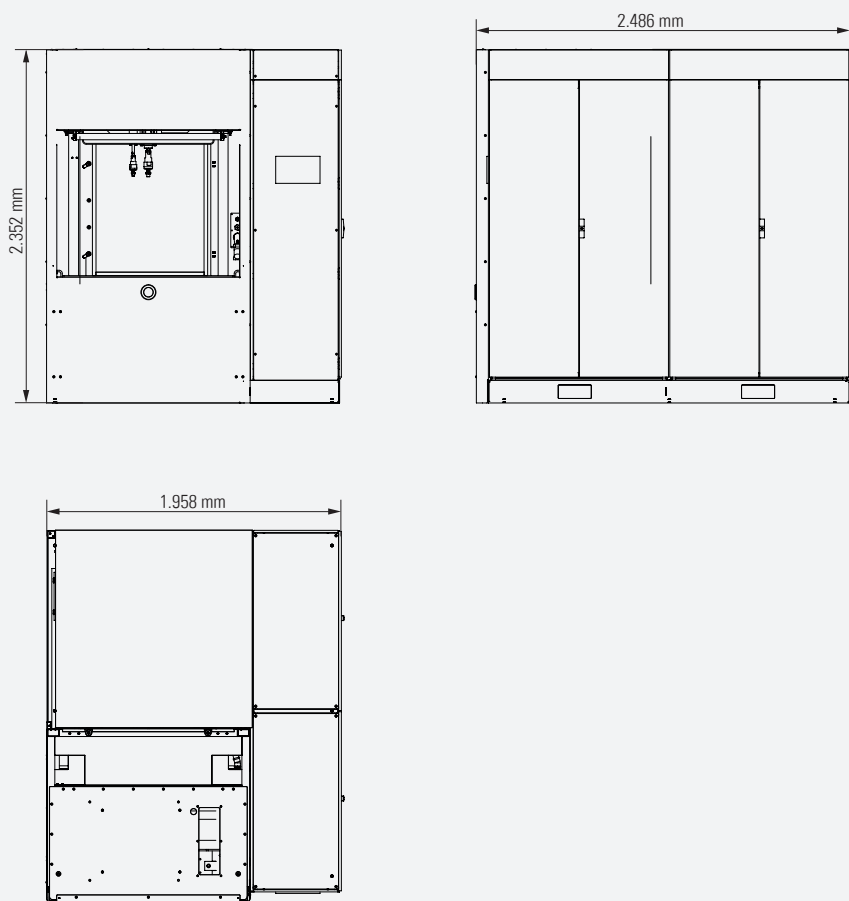

TECHNICAL DATA

Machining area	mm	1,150 x 950
	inch	45 x 37.5
Clamping surface	mm	1,300 x 800 x 900
	inch	51 x 31.5 x 35.5
Generator capacity	A (DC)	400 – 2,500
Generator capacity	A (pulse)	400 – 1,600

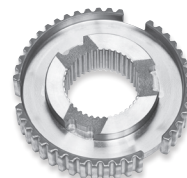
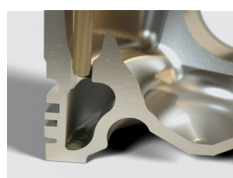

Data subject to change. The layout may change to fit technical requirement.
All systems are built to current CE standards.